

# S1-700 Remote Tank Switch

## Accessory to control the levels of a remote tank in S1-700 systems

### Description

The **Remote Tank Switch (RTS)** accessory provides an effective way to switch off the S1-700 pump when the remote tank is full.

The **RTS** is installed on the discharge pipe close to the pump controller. A float valve (not included) is installed in the tank situated at the end of the discharge line. The **RTS** monitors water flow in the pipeline and based on this, signals to the pump controller to run the pump or not. The pump controller performs periodic startups every 15 minutes\* to monitor water flow.

\* customer changeable in S-Connect app



### Features

- Simple plug-in installation
- Automatic water flow sensor using a magnetic flow device
- Electronic components are sealed and not in contact with water
- Integrated non-return valve
- Adapters included for flexible installation
- Simple activation through the S-Connect App

### Technical Data

Sensor type	Flow Switch
Installation	Pipe
Connector type	Thread female
Pipe size required	1-1/4" or 1-1/2" (pipe male)
Min. flow detection required	1.5 L/min [0.39 gal/min]
Operating temperature range	-10 °C to 70 °C [14 °F to 158 °F]
Enclosure class	IP 54
Non-return valve opening pressure	0.03 bar [0.5 psi]
Body material	Brass
Length of cable	3 m [10 ft]
Cable size	2 x 1 mm <sup>2</sup> [AWG 18]
Plug type	M16 Female
Plug enclosure class	IP 67
Standards requirements	CE

Find more about the S1-700 Remote Tank Switch here



### Additional component required (not included, aquired locally)

The **Remote tank switch** accessory must operate in conjunction with a "**Float valve / ballcock**" or similar located at the end of the discharge pipe. The valve should close the pipe when the tank is full. (Refer to the manual of the **Remote tank switch** for more information).

# S1-700 Remote Tank Switch

## Dimensions and weights

A	50 mm [1.9 in]
D1	G 1-1/4"
D2	G 1-1/2"
D3	G 1-1/2"
H1	93 mm [3.7 in]
H2	98 mm [3.9 in]
W1	57 mm [2.2 in]
W2	53 mm [2.1 in]
L1	150 mm [5.9 in]
L2	165 mm [6.5 in]
Net weight	1.6 kg [3.5 lb]

Without adapters for pipe size 1-1/2"

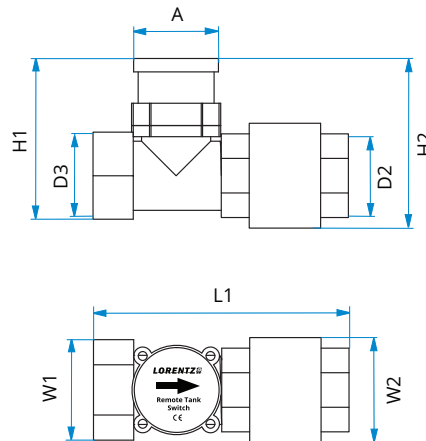

With adapters for pipe size 1-1/4"

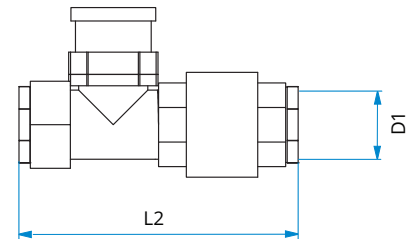

## Activation

- Open the S-Connect app and select your pumping system.
- In the **"Settings"** tab, activate **"Tank Switch"** and select **"Remote tank switch"**.
- The default settings can be changed when required.
- Apply changes

### Important:

Select the correct **"Pump end"**. For more information visit the help site: [www.lorentz.de/s/help](http://www.lorentz.de/s/help)

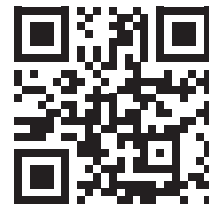
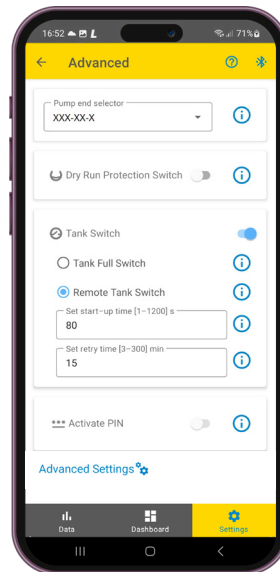

## Order and Packaging information

Item number	19-001640
Product name	S1-700 remote tank switch with 3m / 10ft cable
Box content	1 x Remote tank switch with 3 m [10 ft] cable 1 x Non-return valve 2 x Ø 1-1/4" pipe adaptors 1 x Manual
Packed gross weight	1.7 kg [3.7 lb]
Packaging dimensions [LxWxH]	210 x 180 x 65 mm [8.3 x 7.1 x 2.6 in]
Packed volume	0.002 m <sup>3</sup> [0.071 ft <sup>3</sup> ]